

UHC Universal Holding Cabinet

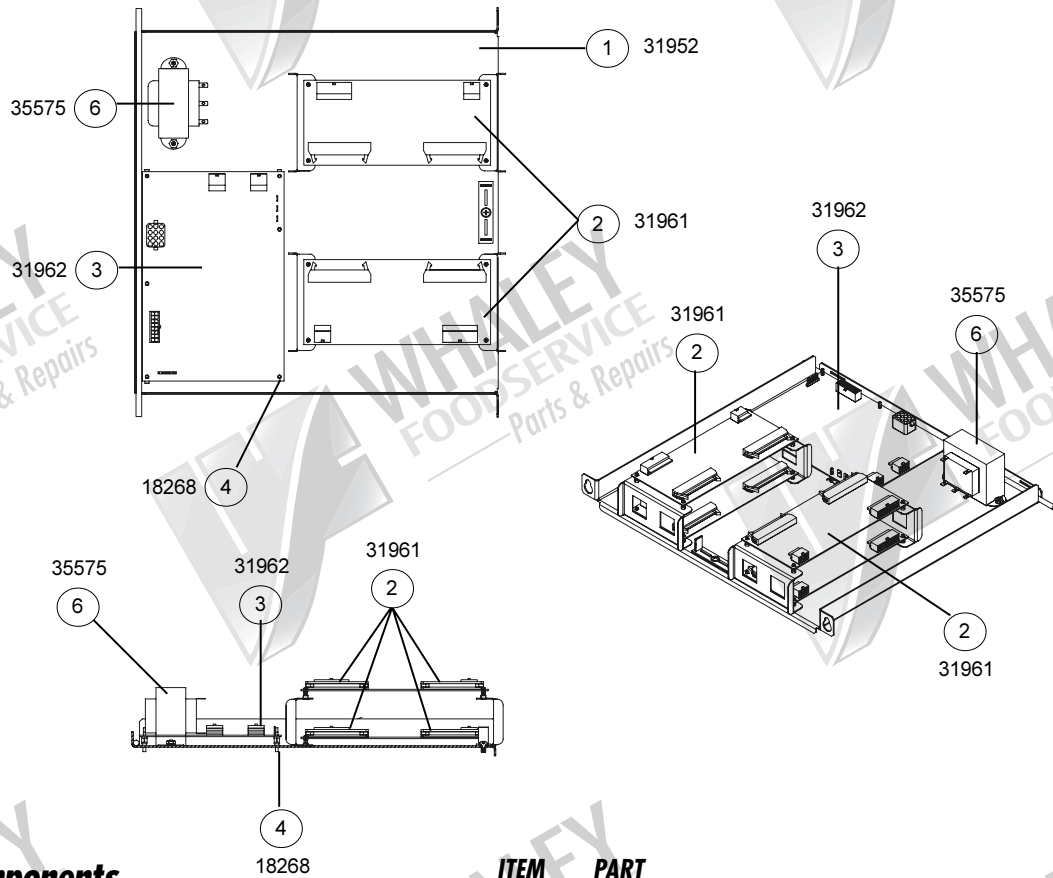

Electrical Components

ITEM NO.	PART NO.	DESCRIPTION
	34015	Cord Set, 6', 1PH, Locking
	34341	Cord Assembly, 6' 1PH Water Tight
	34783	Cord Set, 6', Twist-lock w/Safety Shroud
	31958	Harness, Probe (w/Molex Connector)
	31959	Harness, Element
	33519	Harness, Power Switch
	33520	Harness, Power Board
	33521	Harness, Communications
	34125	Harness, Ribbon Cable, Single (8 qty. Per Oven)
	31937	Terminal Block
	33564	Varistor, MOV 140 Joules
12	33565	Rocker Switch, DPST
11	34101	Shelf Assembly (Includes Element, Probe & Insulation) (4 qty.)
20	34685	Liner Bottom & Heater (Includes Element & Probe)
5	34684	Liner Top & Heater (Includes Element & Probe)

ITEM NO.	PART NO.	DESCRIPTION
	34467	Gasket Kit, Liner Tape (for Entire Unit) (This can ONLY be ordered by our Service Dept.)
	34952	Gasket Kit, Liner Tape (for Sgl Shelf)
10	34100	Blower & Support Assembly
	34474	Fuse, 1.5 Amp, Time Delay (After 3/31/98 or s/n 033198UB150S)

Control Plate Components

ITEM NO.	PART NO.	DESCRIPTION
1	31952	Control Plate & Rod Assembly
6	35575	Transformer & Thermistor Kit 200-240V to 18V
2	31961	Control Board, Shelf (4 qty.)
3	31962	Control, Mother Board
	35139	Chip Kit Upgrade, Mother Board
4	18268	Spacer, Nylon (5 qty.)

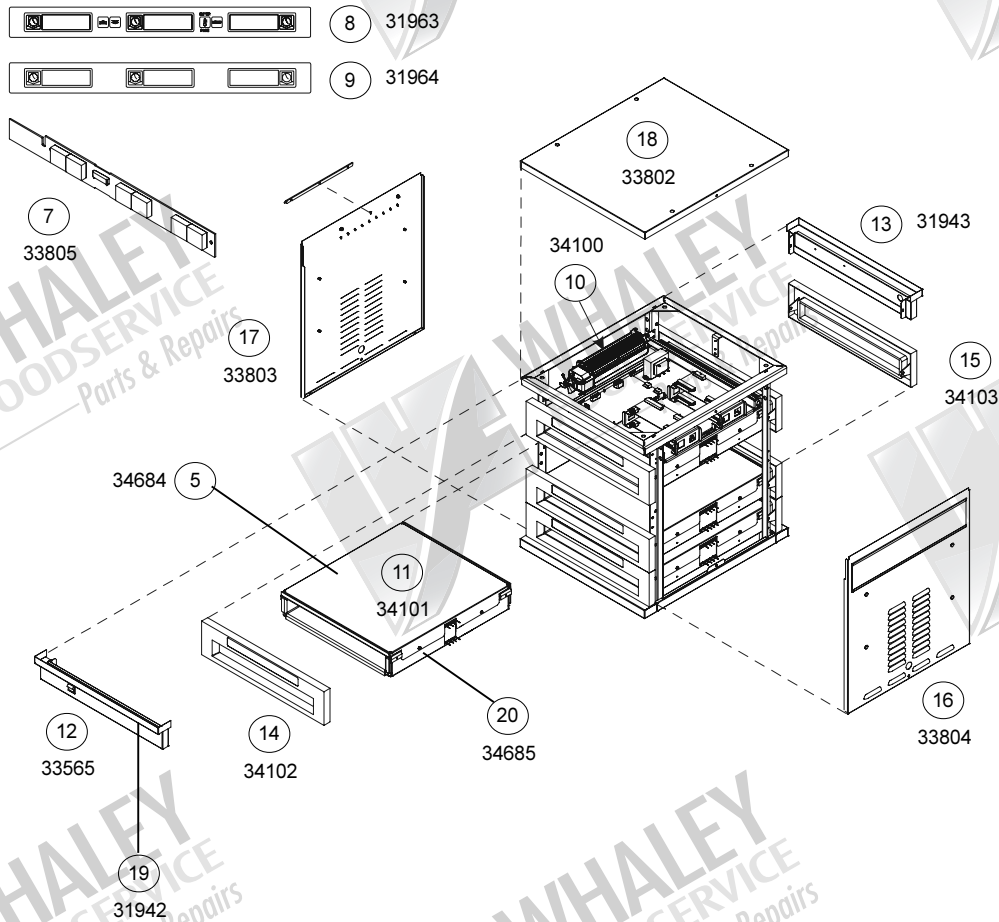

Exterior Components

ITEM NO.	PART NO.	DESCRIPTION
	20435	Legs, 4" (Set of 4)
17	33803	Body Side Assembly, LH
	31936	Drip Deflector
16	33804	Body Side Assembly, RH
18	33802	Body Top
13	31943	Back Panel
19	31942	Front Panel
	33558	Guide, Reference
	33557	Brush
	34091	Maintenance Card
	34092	Instruction Video
	34052	Gasket, Bottom Trim

Bezel Components

ITEM NO.	PART NO.	DESCRIPTION
9	31964	Rear Control Membrane (Timers Only)
7	33805	Control, Display
8	31963	Front Control Membrane ("Enter, Menu, Page" and Timers)
14	34102	Bezel Assembly, Front (Includes Membrane & Gasket)
15	34103	Bezel Assembly, Rear (Includes Membrane & Gasket)
	33828	Gasket, Bezel (Sgl) w/o Adhesive
	34523	Gasket Kit, Bezel w/Adhesive
	34115	Adhesive, Pro-Grip 4000 (for Gaskets)

EF/EZE Series Electric Convection Ovens

Electrical Components

PART NO.	DESCRIPTION
5147	Timer, 60 Minute Mechanical w/Knob
11239	Timer Panel (Without Timer)
11304	Dial Only, 60 Min. Mechanical Timer
16498	Knob Only, 60 Min. Mechanical Timer (After 5/83)
16820	Dial Plate, 60 Min. (for 16498)
10465	Knob Only, 60 Min. Mechanical Timer (Before 5/83)
11324	Timer, 5 Hour Mechanical w/Knob
16948	Timer, 60 Min. for Buzzer w/Knob
16030	Knob Only, 60 Min. Timer for Buzzer
11427	Timer, 6 Hour for Buzzer w/Knob
20349	Electric Buzzer Only, 115V
20350	Electric Buzzer Only, 208/240V
6500	Switch, DPST Blower, Blue (Rocker)
6501	Switch, DPST, Lights, White (Rocker)
6502	Switch, DPDT, Cool Down, Red (Rocker)
9979	Switch, DPST (Toggle Replacement)
6503	Switch, DPDT, Blower, 2SP, Black (Rocker)
5220	Lamp Socket Support
11253	Light Reflector
4922	Lamp Socket
4342	Interior Lamp (50 Watt)
6504	Indicator Light, 250V, Red Rectangle
4908	Indicator Light, 250V, Red (Before 12/68)
11171	Complete Wiring Kit, 208/220V, 1PH, 1SP, EF/EZE
11204	Terminal Block
11261	Transformer, Hi-Volt, 480V to 120 V
8619	Element Assembly, 208/220V, 3 Ring 11KW
8620	Element Assembly, 230/240V, 3 Ring 11 KW
10217	Element Assembly, 440/460V, 3 Ring 11 KW
10218	Element Assembly, 480V, 3 Ring 11 KW
20802	Element Mounting Plate (for 2 to 3 Element Conversion)
5272	Element Terminal Strip
35918	Microswitch, Door Replaces 19978
35419	Bracket, Mounting for Microswitch
11513	Thermostat (K920-36) 140-500
16393	Thermostat Dial 140-500
5279	Thermostat (KX-38-36) 140-550
11224	Thermostat Dial 140-550
11238	Fuse Holder, Low Volt

PART NO.	DESCRIPTION
5255	Fuse, 10 Amp, Low Volt
9640	Fuse, 15 Amp, High Volt, Type J
11476	Fuse, 15 Amp, High Volt, Type CC
11660	Fuse Holder, High Volt, Type CC
11659	High Volt Fuse Conversion Kit, Type J to Type CC
11203	Circuit Breaker
5252	Bracket, Circuit Breaker
90275	Contactora, 50 Amp, 240V Coil (for Low Volt Ovens, 208-240V)
5510	Contactora, 35 Amp, 110V Coil (for High Volt Ovens, 440-480V)
90264	Contactora, 35 Amp, High Volt, 2SP (for High Volt Ovens, 440-480V)
5537	Bracket for Contactora
32232	Motor, 115/230V, 1SP, 1/3HP 1PH
32244	Motor, 230V, 2SP, 1/3HP 1PH
32268	Motor, 208-230/460V, 1 SP, 1/3HP, 3PH
32334	Motor, 460V, 3PH, 2SP
5001	Blower Wheel (10" Diameter)

Cook and Hold Controls

PART NO.	DESCRIPTION
20494	Timer, Cook 'n Hold, 12 Hr., 208-240V
16392	Knob for Hold Thermostat (120-200)
15365	Electric Hold Thermostat (120 - 200 F)
90233	Hold Indicator Light (Low Volt)
15363	Hold Indicator Light (High Volt)
90268	Relay, 10 Amp (High Volt)
90250	Relay, 10 Amp (Low Volt)

Baking Compartment Components

PART NO.	DESCRIPTION
8727	Compartment Liner Bottom EF Porcelain
8728	Compartment Liner Bottom EF SS
8729	Compartment Liner Bottom EZE Porcelain
8730	Compartment Liner Bottom EZE SS
8724	Rack Supports EF-111 (Set of 2) 20" x 19"

Baking Compartment Components

PART NO.	DESCRIPTION
8636	Rack Supports EZE-1 (Set of 2) 27"x19"
4701	Racks (Each) 20-7/8" x 28 1/4" EF-111
6330	Racks (Each) 27-7/8" x 28 1/4" EZE-1
16813	Interior Baffle (Blower Wheel Cover) EF, EZE
16814	Interior Baffle (Blower Wheel Cover) SS EF, EZE
8648	Screws for Baffle (4 qty.)
8646	Support Brackets, Baffle (4 qty.)
20642	Light Guard, Baffle
5001	Blower Wheel, 10" Diameter
10062	Motor Mount & Panel Assembly
8321	Thermostat Bulb Guard
11199	Window for Interior Lights
8316	Interior Window Retainer
90046	Baffle Support Brackets (4 qty.) After 12/85
8646	Baffle Support Brackets (4 qty.) Before 1/86

Door Components

PART NO.	DESCRIPTION
912	Brass Bushings (Welded)
8583	Door Catch (Striker Plate w/Screws)
8584	Door Catch (Ball Plunger w/Nut)
5742	Spanner Key for Ball Plunger Latch
10231	Door, LH w/Glass (Complete)
10232	Door, RH w/Glass (Complete)
10235	Door, LH Solid (Complete)
10236	Door, RH Solid (Complete)
10439	SS Door Conversion Kit
4887	Chain & Turnbuckles
9978	Sprocket Assembly
11698	Cam Assembly, Door Switch (Actuator)
11867	Glass Assembly w/Supports 20-1/2" x 14-1/4" (Replaces 8812 Window, 22-3/8" x 16")
20641	Window Support Brackets
15754	Handle, 14" (After 12/81)

PART NO.	DESCRIPTION
10233	Handle, 21" (Before 12/81)
11080	Hinge Pins w/Bolts (4 qty.)
8846	Hinge Pin Bolts (Each)
11172	Lower Hinge Pin w/Bolts (Square)
11173	Upper Hinge Pin w/Bolts (Round)
90010	Perimeter Gaskets, SS
10471	Center Door Gasket, Metal (2 qty.)
11695	Washers (12 qty.)
35419	Door Switch Bracket
35918	Microswitch, Door Replaces 19978

Old Style Doors

OVENS MANUFACTURED BEFORE 6/76

ITEM NO.	PART NO.	DESCRIPTION
9037		Window, 17-1/8" x 10-3/16"
9038		Handle, 20"
8608		Hinge Pins w/Screws
11320		Upper Hinge Pin w/Screws (Round)
11321		Lower Hinge Pins w/Screws (Round)
4155		Screw for Upper Hinge Pin (Allen Head) Each
4832		Screw for Lower Hinge Pin (Allen Head) Each
7801		Center Door Gasket
<p>► NOTE: SS Perimeter Gaskets Replace both fiberglass and silicone gaskets fitted to earlier ovens. Units manufactured before 3/67 require Perimeter Gasket w/Side Trim, Part Number 11541</p>		

RHT and High Input Ovens

PART NO.	DESCRIPTION
15321	Inner Element Assembly, 208/220V, 3 Ring 7.5 KW
15322	Inner Element Assembly, 230/240V, 3 Ring 7.5 KW
15312	Inner Element Assembly, 440V, 3 Ring 7.5 KW
15313	Inner Element Assembly, 480V, 3 Ring 7.5 KW
10157	Switch Kit (RHT Only)
10054	Selector Switch, Rocker 208/240V, High Input Only
10053	Selector Switch, Rocker 440/480V, High Input Only



Exterior Components

PART NO.	DESCRIPTION
7839	Draffhood & Adapter, Direct Vent FA-100 (6" Diameter)
8710	Draffhood & Adapter, Direct Vent GZL-10 (6" Diameter)
8712	Draffhood, Direct Vent, FA-102/GZL-10 (8" Diameter)
7840	Draft Diverter, Canopy Vent, FA-100/GZL-10
20447	Draft Diverter, Canopy Vent, FA-102/GZL-20 SS
20443	Flue Box (Sgl Stack)
17943	Flue Connector (4 Pieces) FA-102/GZL-20 (DbI Stack)
23190	Crown Assembly, EF
8600	Legs, 6", SS (4 qty.)
8598	Legs, 25", SS (4 qty.)
7847	Leg Bolts (8 qty.)
92000	Leg Studs (4 qty.)
8319	Control Panel Assembly (Rocker Switch Type)
8601	Nameplate Panel (Includes Nameplate)
11255	BLODGETT Nameplate
8318	Steam Vent Lever w/Spring
17766	Vent Assembly (EF-112 & EZE-2)
8315	Louvered Back Panel, Ptd.
8317	Louvered Back Panel, SS
8314	Service Connection Cover
18879	Security Latch ("On Board Ship Latch")
5779	Caster Kit w/Plate, (Set of 4; Double)
16002	Casters, (Set of 4; Single)
6486	Open Stand w/Feet, SS, EF
11416	Open Stand w/Casters, SS, EF
6539	Open Stand w/Feet, SS, EZE
11239	Timer Panel Assembly

Roll-In Units and Parts

(EF USES S9; EZE USES L9)

PART NO.	DESCRIPTION
8354	Docking Assembly, RI
8355	Docking Pins, Transport Cart (2 qty.)
8356	Casters, 5" for Transport Cart (4 qty.)
9052	Handle, Transport Cart (Single Unit)
8359	Catch Mechanism, Transport Cart
8357	Locking Bar, Transport Cart
8358	Tracks & Shelf Assembly, Transport Cart
9015	Handle, Double Transport Cart
9016	Vertical Posts, Each
9017	Upper Tracks & Shelf Assembly, DbI Transport Cart
9389	Oven Liner Tracks (Set) EF-RI
9388	Oven Liner Tracks (Set) EZE-RI
7514	Transport Cart, CTRE
8542	Transport Cart, CTRE-2
7365	Roll-In Basket Dolly, DBRI-L
7969	Roll-In Basket Dolly, DBRI-S
11206	Roll-In Pan Rack, RPR-L9 w/5 Racks
11207	Roll-In Pan Rack, RPR-S9 w/5 Racks
7590	Racks for Pan Rack, L9
8677	Racks for Pan Rack, S9



Whaley Foodservice Repairs is proud of our 60 years of dependable, reliable service and we bring it to work with us every day.



Mark V Series Electric Convection Oven

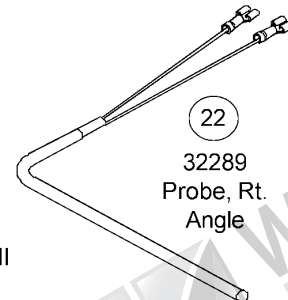
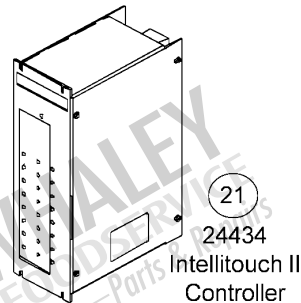
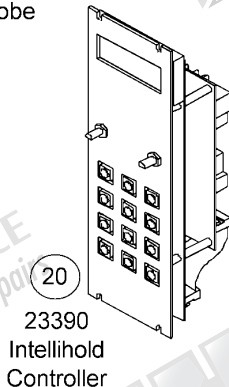
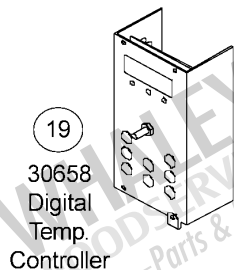
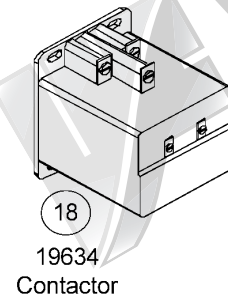
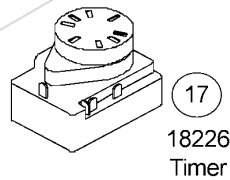
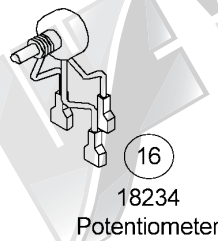
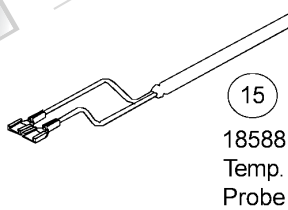
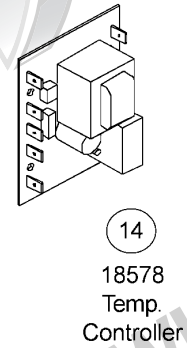
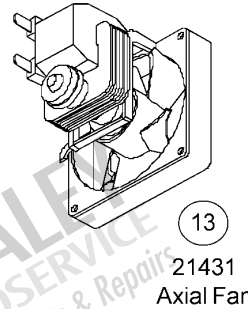
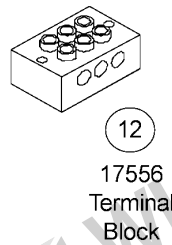
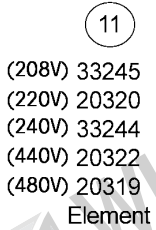
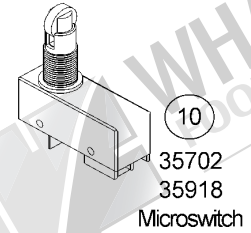
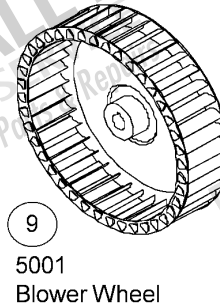
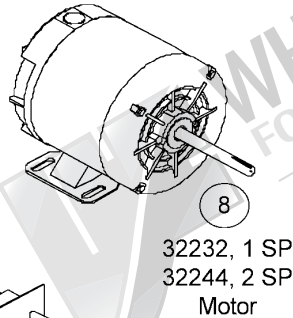
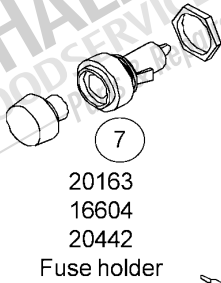
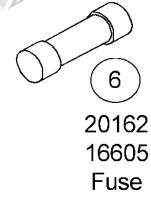
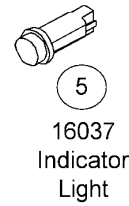
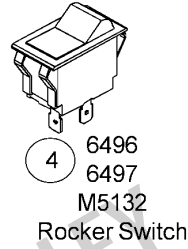
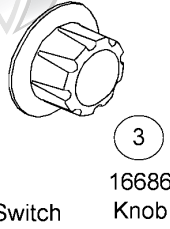
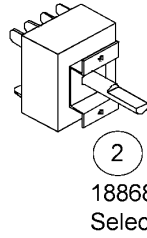
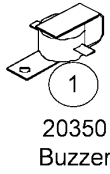

(Illustration on page 89.)

Electrical Components

ITEM NO.	PART NO.	DESCRIPTION
1	20350	Buzzer, 240V
2	18868	Selector Switch w/o Knob, Mode (3 Positions)
3	16686	Knob, Mode Selector Switch
4	6496	Blower Switch, Rocker, SPST, Blue, 1 SP (Before 1/8/85)
	17857	Blower Switch, Rocker, SPDT, Black, 2 SP (Between 1/8/85 and 3/01/94)
	30518	Blower Switch, Rocker, SPDT, Matt Black, 2 SP (After 3/01/94)
4	6497	Light Switch, Rocker, SPST, White (Before 3/01/94)
4	M5132	Light Switch, Rocker, SPST, Matt Black (After 3/01/94)
	6498	Cool Down Switch, Rocker, SPDT, Red (Before 1/8/85)
5	16037	Indicator Light, 250V, Red, Round (Cook Only)
6	16605	Fuse, 600V,10 Amp (Before 6/88 & After 02/15/97)
7	16604	Fuse Holder (Before 6/88) Intelli II
6	20162	Fuse, 300V, 10 Amp (Between 6/88 & 02/15/97)
7	20163	Fuse Holder (Between 6/88 & 02/15/97)
7	20442	Fuse Holder, 30 Amp, Class CC (After 02/15/97)
8	32232	Motor, 208-240V, 1 SP
8	32244	Motor, 208-240V, 2 SP
	34469	Harness, Motor Centrifugal Switch 1 SP After 11/01/99 or s/n 110199PA002T
	34470	Harness, Motor Centrifugal Switch 2 SP After 11/01/99 or s/n 110199PA002T
9	5001	Wheel Assembly, Blower
	19667	Mount & Panel Assembly, Motor
10	35702	Microswitch & Bracket Assembly, Door Replaces 19978, Units After 06/84
10	35918	Microswitch Assembly, Door Replaces 19978 Units Before 06/84
	35419	Bracket, Microswitch
	90047	Socket, Quick Disconnect

ITEM NO.	PART NO.	DESCRIPTION
	20662	Plug, Quick Disconnect
	4888	Lug, Grounding
11	33245	Element Assembly, 208V
11	20320	Element Assembly, 220V
11	33244	Element Assembly, 240V
11	20322	Element Assembly, 440V
11	20319	Element Assembly, 480V
	20604	Cover for Terminal, Ends on Back
	17754	Transformer, High Volt, 480V to 240V
	17252	Bracket, Transformer
	19453	Voltage Conversion Kit, 208V-480V
12	17556	Terminal Block, 90 Amp, 3 Pole
13	21431	Axial Fan, 230V All Units Before 09/01/99
<p>► NOTE: For units before 09/01/99 this is the only fan. After 09/01/99, it became the TOP fan. s/n 090199PA010S</p>		
13	21430	Axial Fan, 230V Bottom Fan
<p>► NOTE: For units after 09/01/99 this is the BOTTOM fan. Ovens built before 09/01/99-this fan is not in the oven. s/n 090199PA010S</p>		

Mechanical Controls

STANDARD ON OVENS MANUFACTURED BEFORE 9/1/86

ITEM NO.	PART NO.	DESCRIPTION
	15956	Timer, 60 Minute w/o Knob (Cook Only)
	16030	Knob, Timer
	16536	Thermostat, Cook KX-234-36 w/o Knob (140° - 500°)
3	16686	Knob, Thermostat
	90316	Contactora, 50 Amp
	16806	Control Panel Decal, Cook (Before 6/1/84)
	17905	Control Panel & Decal, Porcelain, Cook 1 SP, (Between 6/1/84 and 9/1/86)
	17264	Control Panel & Decal, Porcelain, Cook, 2 SP, (Before 1/8/85)
	17906	Control Panel & Decal, Porcelain, Cook, 2 SP, (Between 1/8/85 and 9/1/86)

Solid State Manual Controls

STANDARD ON OVENS MANUFACTURED AFTER 7/86

ITEM NO.	PART NO.	DESCRIPTION
14	18578	Control Board, Solid State Temperature
15	18588	Probe, Temperature
16	18234	Potentiometer, Remote (Infinite Control)
	18577	8 Position Temperature Switch (Specify Model & Temperature Settings)
3	16686	Knob, 8 Position Temperature Switch
17	18226	Timer, 60 Minute 240V
3	16686	Knob, 60 Minute Timer
	19428	Timer, 6 Hour 240V
	19518	Dial, 6 Hour Timer
18	19634	Contactator, Mercury, 208/440V, 3 Pole, 30 Amp, 3 PH (8 Set Point or Infinite)
	18651	Contactator, Mercury, 208V, 2 Pole, 60 Amp, 1 PH (8 Set Point or Infinite)
	18352	Harness, Wiring (8 Set Point or Infinite, (1 SP)
	18351	Harness, Wiring (8 Set Point or Infinite, (2 SP)
	18283	Control Panel & Decal, Infinite, 1 SP
	18281	Control Panel & Decal, Infinite, 2 SP
	18280	Control Panel & Decal, 8 Set Point, 1 SP
	18278	Control Panel & Decal, 8 Set Point, 2 SP

Solid State Digital Controls

ITEM NO.	PART NO.	DESCRIPTION
19	30658	Controller, Solid State Digital
	FW529	Controller, Reconditioned
15	18588	Probe, Temperature
	24684	Knob, Mode (for 30658)
	24685	Knob, Adjust
2	18868	Selector Switch w/Knob, Mode (3 Position) 1 SP
	21068	Selector Switch w/Knob, Mode (4 Position) 2 SP
3	16686	Knob, Mode Selector Switch
	30662	Light Switch, Momentary
	23086	Suppressor Assembly, RC
	24924	Harness, Wiring (1 SP)
	24920	Harness, Wiring (2 SP)
	30666	Control Panel & Decal, 1 SP
	30667	Control Panel & Decal, 2 SP
	30670	Control Cover Assembly

Fan Delay with Pulse Points

ITEM NO.	PART NO.	DESCRIPTION
	18291	Timer, Fan Delay, 10 Minute, 240V
	18293	Timer, Fan On, 30 Minute, 240V
	18583	Timer, Solid State, Pulsing, 30 Second, 240V
	16539	Indicator Light, 250V, Amber, Round
	18582	Relay, 3PDT, 240V w/Bracket
	18355	Harness, Wiring (8 Set Point or Infinite, 2 SP)
	18679	Control Panel & Decal, Porcelain, Infinite
	18277	Control Panel & Decal, Porcelain, 8 Set Pt.
	16686	Knob

Cook and Hold Controls

ITEM NO.	PART NO.	DESCRIPTION
	17984	Timer, 12 Hour w/Knob (Before 2/25/85)
	17863	Timer, 12 Hour w/o Knob (After 2/25/85)
3	16686	Knob, Timer
	15365	Thermostat, Hold K-877-36 w/o Knob (120° - 200°)
	16392	Knob, Thermostat
	20351	Controller, Temperature Hold (150° - 250°)
3	16686	Knob, Temperature Hold Controller
15	18588	Probe, Temperature
2	18868	Selector Switch w/o Knob, Mode (3 Positions) (Before 1/18/85)
	20347	Selector Switch w/o Knob, Mode (4 Positions) (After 1/18/85)
3	16686	Knob, Mode Selector Switch
	16539	Indicator Light, 250V, Amber, Round Hold Only
	19666	Relay, Motor, 25 Amp, DPDT, 240V
	18780	Harness, Wiring (1 SP)
	18870	Harness, Wiring (2 SP)
	16779	Control Panel Decal (Before 6/1/84)
	17262	Control Panel & Decal, Porcelain, 1 SP & 2 SP (Between 6/1/84 and 1/8/85)
	17907	Control Panel & Decal, Porcelain, 1 SP (Between 1/8/85 and 8/86)
	17908	Control Panel & Decal, Porcelain, 2 SP (Between 1/8/85 and 8/86)
	18746	Control Panel & Decal, Porcelain, 1 SP (After 8/86)
	18747	Control Panel & Decal, Porcelain, 2 SP (After 8/86)

CTB/CTBR Electric Convection Oven

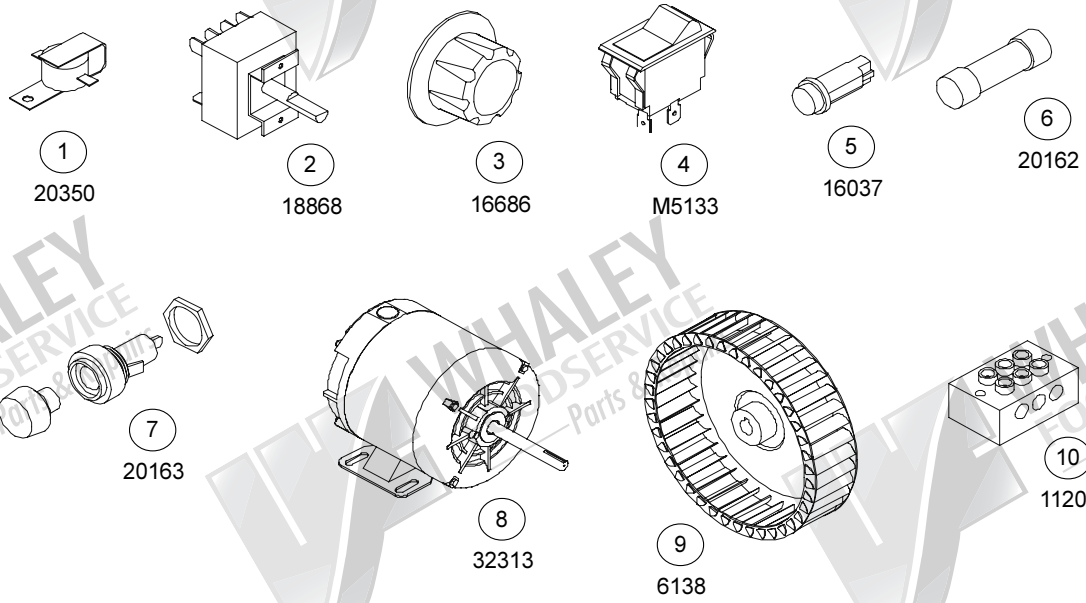

Electrical Components

ITEM NO.	PART NO.	DESCRIPTION
1	20350	Buzzer, Electric 240V
2	18868	Mode Selector Switch w/o Knob, 1 SP
	21068	Mode Selector Switch w/o Knob, 2 SP
3	16686	Knob, Mode Selector Switch
4	M5133	Cool Down Switch, Rocker SPDT Matt Black
5	16037	Indicator Light, 250V, Red, Round
	16605	Fuse, 10 Amp (Before 6/88 and After 01/20/97)
6	20162	Fuse, 10 Amp (Between 6/88 and 01/20/97)
	20442	Fuse Holder (After 01/20/97)
7	20163	Fuse Holder (Between 6/88 and 01/20/97)
	16604	Fuse Holder (Before 6/88)
8	32313	Motor, 230V, 1 PH, 1/4 HP, 1 SP
	32302	Motor, 230V, 1 PH, 1/4 HP, 2 SP
9	6138	Blower Wheel Assembly, (8-1/2" Diameter)
10	11204	Terminal Block w/Screws
	4888	Lug, Grounding
	34898	Cord Set Assembly w/Receptacle, 3 PH
	34899	Cord Set Assembly w/Receptacle, 1 PH
	19118	Element Assembly, 208V, 5 KW
11	8596	Element Assembly, 230V, 5 KW
	8595	Element Assembly, 240V, 5 KW
	19284	Element Assembly, 208V, 7.5 KW
	90097	Element Assembly, 230V, 7.5 KW

ITEM NO.	PART NO.	DESCRIPTION
	90098	Element Assembly, 240V, 7.5 KW
► NOTE: 2 ELEMENT RINGS IN ELEMENT ASSEMBLY = 5 KW 3 ELEMENT RINGS IN ELEMENT ASSEMBLY = 7.5 KW		
	16880	Microswitch Assembly, Door (Before 02/14/97)
	33946	Microswitch Assembly, Door (After 02/14/97)
	33286	Activator, Door Switch (Before 07/17/98) Used with 33946
	34524	Activator, Door Switch (07/17/98 and After) Used with 33946
	6177	Microswitch Plate (Used with 16880)
13	21430	Axial Fan Kit, 3", 230V (Before 05/22/97 or s/n 052297LA035S)
13	23034	Axial Fan Kit, 4", 230V (After 05/22/97 or s/n 052297LA035S)

Controls

FOR OVENS MANUFACTURED BEFORE 9/86

ITEM NO.	PART NO.	DESCRIPTION
	15956	Timer, 60 Minute w/o Knob (Cook Only)
	16030	Knob, Timer
	16536	Thermostat, Cook KX-234-36 w/o Knob (140° - 500°)
	17212	Knob, Thermostat
	90588	Contactator, 50 Amp
	16607	Control Decal, Lexan (Cook Only)

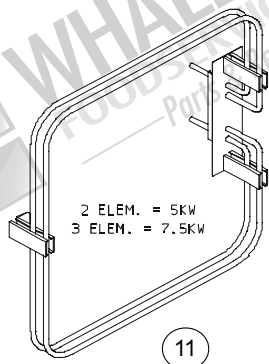

11
8596

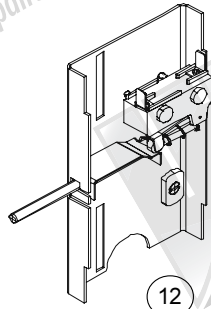

12
16880
See Description

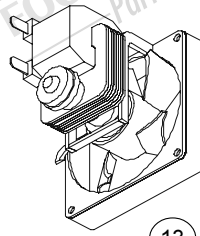

13
21430

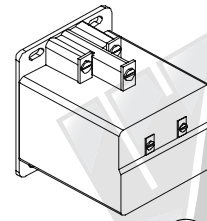

14
19634

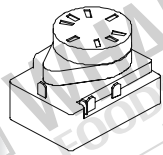

15
18226

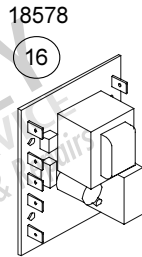

16
18578

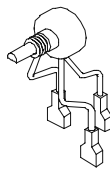

18
18234

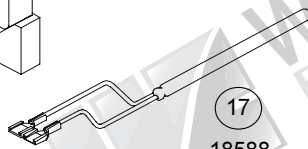

17
18588

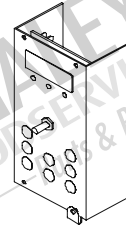

19
30658

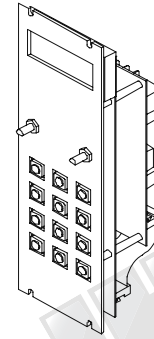

20
23390

Controls

FOR OVENS MANUFACTURED BEFORE 7/83

ITEM NO.	PART NO.	DESCRIPTION
	5147	Timer, 60 Minute Mechanical w/Knob
	16498	Knob, Timer 60 Minute Mechanical
	11304	Dial, 60 Minute Mechanical Timer
	16948	Timer, 60 Minute for Electric Buzzer w/Knob
	16820	Dial Plate
	16030	Knob, 60 Minute Timer for Electric Buzzer
	5279	Thermostat, KX-38-36 w/o Knob (140° -550°)
	11224	Dial, Thermostat
	6502	Cool Down Switch, Rocker DPDT, Red
	6500	Blower Switch, Rocker DPST, Blue
	6504	Indicator Light, 250V, Red, Rectangular
	5255	Fuse, 10 Amp
	11238	Fuse Holder
	8592	Control Panel Assembly, CTB-1
	9637	Control Panel Assembly, CTBR-1

Solid State Manual Controls

STANDARD ON OVENS MANUFACTURED AFTER 9/86

ITEM NO.	PART NO.	DESCRIPTION
	20346	Temperature Controller, 3 Positions (Specify Model & Temperature Settings)

ITEM NO.	PART NO.	DESCRIPTION
	21432	Temperature Controller, 1-Position (Specify Model & Temperature Settings)
	16645	Probe, Temperature (For 1 & 3 Position Controllers) (2 Wires)
	16536	Thermostat, KX-234-36, Back-Up
16	18578	Temperature Control Board, Solid State
17	18588	Probe, Temperature
18	18234	Potentiometer, Remote (Infinite Control)
	18577	8 Position Temperature Switch (Specify Model & Temperature Settings)
	16686	Knob, 8 Position Temperature Switch
15	18226	Timer, 60 Minute 240V
	16686	Knob, Timer
	90099	Heat Selector Switch, 3 Positions w/o Knob (Used w/20346)
	16686	Knob, Heat Selector Switch
14	19634	Contactor, Mercury, 3 Pole, 30 Amp (5 KW)
	90069	Contactor, Mercury, 3 Pole, 35 Amp (7.5 KW)
	18651	Contactor, Mercury, 2 Pole, 60 Amp (5 KW or 7.5 KW)
	16685	Control Decal, Lexan (3 Position)
	22929	Control Decal, KFC Only (3 Position w/o Timer)
	22018	Control Decal, Lexan (Infinite Cook Only)
	18908	Control Decal, Lexan (8 Set Point Cook)
	30465	Rocker Switch, DPDT (For 1 or 3 Set Pt. Only)
	16637	Decal, Wendy's

Solid State Digital Controls

5 KEY

ITEM NO.	PART NO.	DESCRIPTION
19	30658	Controller, Time/Temp (5 Key)
	FW529	Controller, Recond. Time/Temp (5 Key)
17	18588	Probe, Temperature
	24685	Knob, Adjust
	24684	Knob, Mode
	30662	Momentary Light Switch
	16880	Microswitch Assembly, Door
	23086	Suppressor Assembly
	30668	Control Panel & Decal Assembly, 1 SP
	30669	Control Panel & Decal Assembly, 2 SP

Fan Delay with Pulse Plus

ITEM NO.	PART NO.	DESCRIPTION
	18291	Timer, Fan Delay, 10 Minute, 240V
	18293	Timer, Fan On, 30 Minute, 240V
	18583	Timer, Solid State, Pulsing, 30 Second, 240V
	16539	Indicator Light, 250V, Amber
	18582	Relay, 3PDT, 240V w/Bracket
	18910	Control Decal, Lexan (8 Set Point)
	18911	Control Decal, Lexan (Infinite)

Cool and Hold Controls

ITEM NO.	PART NO.	DESCRIPTION
	17982	Timer, 12 Hour w/Knob (Before 3/7/85)
	17863	Timer, 12 Hour w/o Knob (After 3/7/85)
	16686	Knob, Timer
	15365	Thermostat, Hold K-877-36 w/o Knob (120° - 200°) (Before 9/86)
	16392	Knob, Hold Thermostat
	20351	Temperature Controller, Hold (150° - 250°) (After 9/86)
	16686	Knob, Hold Temperature Controller
	18588	Probe, Temperature

ITEM NO.	PART NO.	DESCRIPTION
	18868	Mode Selector Switch w/o Knob (Before 9/86)
	20347	Mode Selector Switch w/o Knob (After 9/86)
	16686	Knob, Mode Selector Switch
	16539	Indicator Light, 250V, Amber, Round, Hold
	90268	Relay, 10 Amp, 3PDT
	17926	Microswitch Assembly, Door Dble (Before 9/86)
	16608	Control Decal, Lexan (C & H) (Before 9/86)
	18907	Control Decal, Lexan (Infinite Cook & Hold) (After 9/86)

Intellitouch Controls

17 KEY

ITEM NO.	PART NO.	DESCRIPTION
	20780	Temperature Controller, Integrated (Specify Model & Temperature Settings)
	20360	Probe, Temperature Integrated
	20112	RFI Filter (Used w/Integrated Controller)
	20660	Contactors, Mercury, 3 Pole, 35 Amp, 24V Coil (For 5 KW) 1SP
	20691	Contactors, Mercury, 3 Pole, 60 Amp, 24V Coil (For 7.5 KW) 2SP
	19341	Relay, SPDT, 24v, 2 SP
	19634	Contactors, Mercury 3 Pole, 30 Amp, 2SP
	90069	Contactors, Mercury 35 Amp, 2SP
	18651	Contactors, Mercury 60 Amp, 2SP
	18979	Metal Oxide Varistor Assembly
	20356	Transformer, 230V to 24V
	17926	Microswitch Assembly, Door Double, 1SP
	20167	Control Panel & Decal Assembly (Before 10/87)
	19189	Control Panel & Decal Assembly (After 10/87)

DFG-100/200 Series Gas Convection Ovens

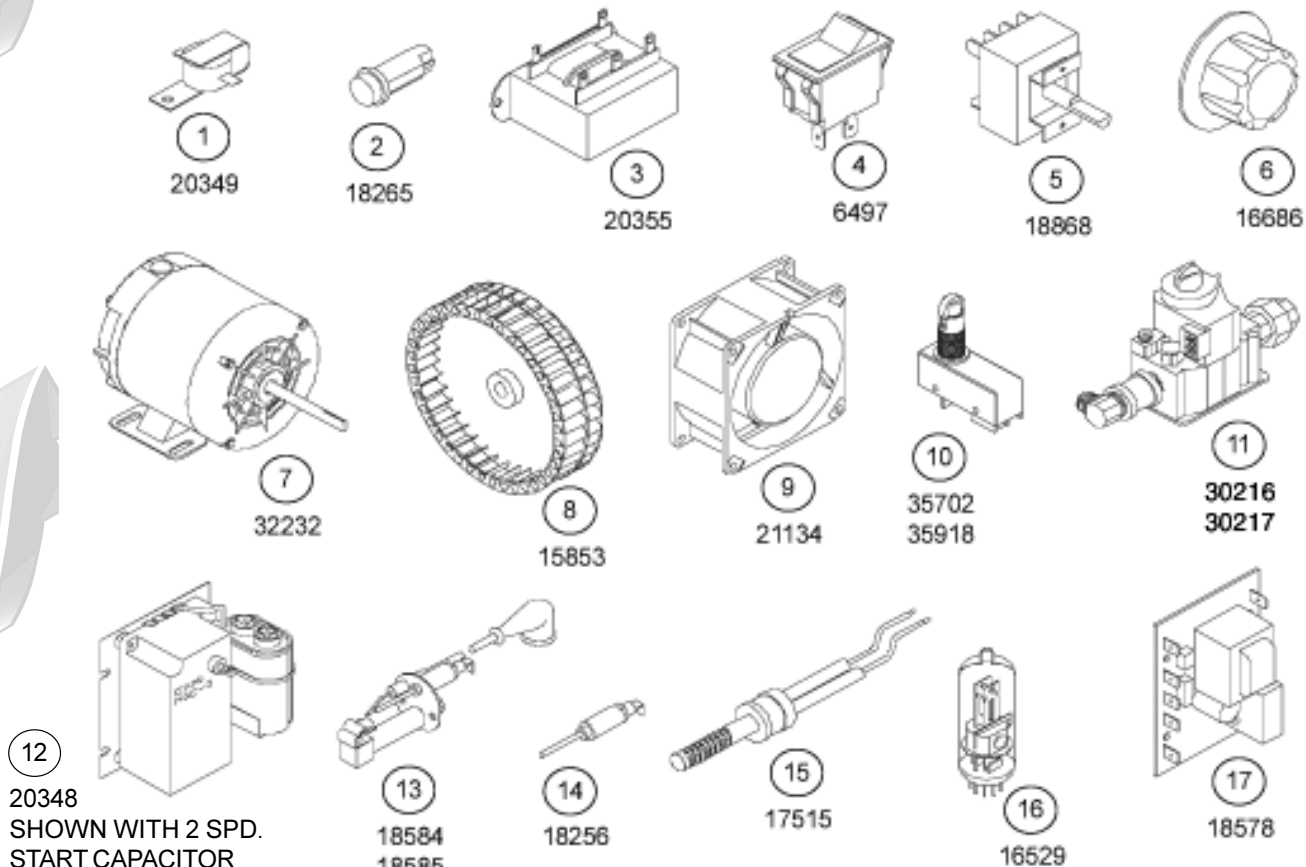

Electrical Components

ITEM NO.	PART NO.	DESCRIPTION
1	20349	Buzzer, for 115V Timer
2	18265	Indicator Light, Red, Round, 28V
3	20355	Transformer, 115V to 24V
	3574	Terminal Block, for Ovens Before 02/05/99
	30503	Terminal Block, for Ovens On/After 02/05/99
	20662	Plug, Quick Disconnect
	90047	Socket, Quick Disconnect
	16326	Test Cord
4	6497	Light Switch, SPST, White
5	18868	Mode Selector Switch w/o Knob
6	16686	Knob, Replacement
	5091	Cord Set Assembly
	90034	Grounding Lug
7	32232	Motor, 115V, 1PH, 1/3 HP, 1 SP
	32291	Motor, 115V, 1PH, 1/3 HP, 2 SP

ITEM NO.	PART NO.	DESCRIPTION
8	15853	Blower Wheel, 10-3/4" Diameter
	33147	Wheel Puller
	23077	Capacitor, 2 SP Only
	19341	Relay, SPDT, 24V, 2 SP
	20530	Blower Switch, Rocker, 3PDT, Black, 2 SP
	6496	Blower Switch, Rocker, SPST, Blue (Before 7/84)
	6498	Cool Down Switch, Rocker, SPDT, Red (Before 7/84)
	90062	Contact, 35 Amp (Before 7/84)
9	21134	Axial Fan, Low Velocity, 115V, 60 HZ
10	35702	Microswitch & Bracket Assembly, Door Replaces 19978 Units After 07/84 and 08/31/00
10	35918	Microswitch Assembly, Door Replaces 19978 Units Before 07/84
	35419	Bracket, for Microswitch

Spark Ignition System

STANDARD FOR OVENS MANUFACTURED AFTER 1/86

ITEM NO.	PART NO.	DESCRIPTION
11	30216	Dual Solenoid/Pressure Regulator, Nat
11	30217	Dual Solenoid/Pressure Regulator, LP
12	20348	Spark Box, LP & Nat
	34689	Capacitor Assembly, Snubber (After s/n 010599RA027T)
	18792	Mounting Plate, Ignition Control
	18584	Pilot Burner, Complete, Nat
13	18585	Pilot Burner, Complete, LP
14	18256	Flame Sensor Probe, Only
	19677	Wire, Flame Sensor
	18263	Orifice, Pilot, Nat
	18257	Orifice, Pilot, LP
	18586	Tube Assembly, Pilot
	20195	Spark Gap Gauge

ITEM NO.	PART NO.	DESCRIPTION
	16393	Dial, Thermostat
16	16529	Thermal Delay Relay Tube Only
	17962	Base & Bracket, TDR Tube (Between 7/84 & 2/86)
	21437	Base & Bracket, TDR Tube (Cook) (Before 7/84)
	21435	Base & Bracket, TDR Tube (C & H) (Before 7/84)
	17428	Wiring Harness, 115V, Cook Only (After 7/84)
	17269	Decal, Control Panel (Cook) (After 7/84)
	90006	Decal, Control Panel (Cook) (Before 7/84)
	19097	Steel Tube Burners (Set of 2) (Before 2/86) (Not for use with IID)
	90023	Manifold Tube
	16589	Thru Pipe Assembly
	90025	Valve, Manual Gas Shut-Off
	10252	Union, 1/2"

Hot Surface Ignition

STANDARD FOR OVENS MANUFACTURED BEFORE 2/86

ITEM NO.	PART NO.	DESCRIPTION
	15956	Timer, 60 Minute, Cook Only (Before 8/86)
	16030	Knob, 60 Minute Timer
	11427	Timer, 6 Hour, Mech. Switch
	16498	Knob, 6 Hour Timer
	90029	Terminal Block (Before 2/86)
	15673	Indicator Light, Red, Cook Only, 125V
	18414	Bracket, Ignitor (Between 7/84 & 2/86)
	20357	Shield, Ignitor (Between 7/84 & 2/86)
15	17515	Ignitor w/Bracket, Replacement
	20325	Solenoid Valve/Pressure Regulator, Nat (Between 7/84 & 2/86)
	20275	Solenoid Valve/Pressure Regulator, LP (Between 7/84 & 2/86)
	20287	Solenoid Valve, Single (Before 7/84)
	90013	Pressure Regulator, Nat (Before 7/84)
	90020	Pressure Regulator, LP (Before 7/84)
	16372	Fuse, 5 Amp
	20658	Fuse Holder
	11513	Thermostat, Cook Only (Before 8/86)

Solid State Manual Controls

STANDARD AFTER 7/86

ITEM NO.	PART NO.	DESCRIPTION
	18577	8 Position Temperature Switch (Specify 8 Temps if Other Than Standard)
17	18578	Controller, Temperature (Solid State Board)
18	18588	Probe, Temperature (Solid State)
19	18234	Potentiometer, Remote (Infinite Control)
20	18225	Timer, 60 Minute, 120V, 60 HZ
6	16686	Knob, Replacement
	18357	Wiring Harness (8 Set Point & Inf. 1 SP)
	20018	Wiring Harness (8 Set Point & Inf. 2 SP)
	18284	Control Panel, Porcelain (Infinite 1SP)
	20011	Control Panel, Porcelain (Infinite 2 SP)
	18286	Control Panel, Porcelain (8 Set Point)
	7149	Rocker Switch (Hi-Lo Fan Speed)

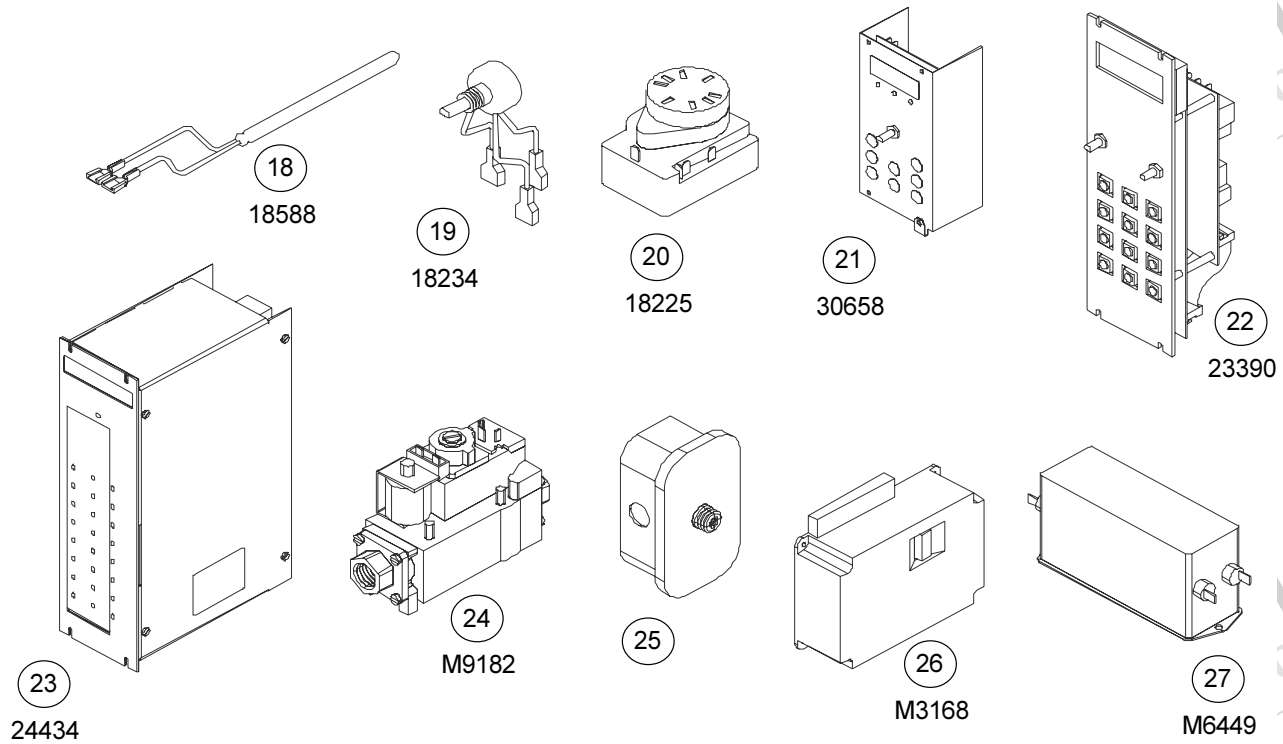

Time and Temperature Digital Controls

5 KEY

ITEM NO.	PART NO.	DESCRIPTION
21	30658	Controller, Time & Temperature Digital (TNT)
	FW529	Controller, Reconditioned
18	18588	Probe, Temperature
	30662	Switch, Momentary Light (Round)
	16241	Motor Speed Relay, 3PDT, 120V
5	18868	Mode Selector Switch (3 Position) 1 SP
	20347	Mode Selector Switch (4 Position) 2 SP
	24684	Knob, Mode (for 18868/20347)
	24685	Knob, Adjust (for 30658)
	24928	Wiring Harness (1 SP)
	24930	Wiring Harness (2 SP)
	30671	Control Cover Assembly, DFG-100
	30672	Control Cover Assembly, DFG-200
	30664	Control Panel & Decal, 1 SP
	30665	Control Panel & Decal, 2 SP
	20348	Spark Box, LP & Nat

ITEM NO.	PART NO.	DESCRIPTION
	16686	Knob, Control
3	20355	Transformer, 115V to 24V
	19341	Relay, SPDT, 24V
	20112	Filter, Intellitouch
	20530	Switch, Rocker, 3PDT, Black 2 SP
	19462	Wiring Harness 1 SP
	20020	Wiring Harness 2 SP
	19588	Control Panel w/Decal 1 SP
	31699	Control Panel w/Decal 2 SP
	18934	Aluminum Spacer

Intelliplus or Intellihold

REQUIRES 2SP MOTOR, CAPACITOR & BLOWER SWITCH 12 OR 13 KEYS

ITEM NO.	PART NO.	DESCRIPTION
22	23390	Controller, 12 Key Intellihold
	23391	Controller, 13 Key Intelliplus
	23392	Probe, Temperature
	21443	Knob, Cntrl.
	16686	Knob, Cntrl.
	19620	Switch, Rocker, DPST, Black
	17857	Switch, Rocker, SPDT, Black, 2 SP
	90043	Relay, Motor, DPDT, 120V, 30 Amp
	21844	Wiring Harness (Intelliplus or Intellihold)
	23393	Control Panel w/Decal Assembly, Intellihold
	23394	Control Panel w/Decal Assembly, Intelliplus

Intellitouch

17 KEY

ITEM NO.	PART NO.	DESCRIPTION
	20780	Controller, Intellitouch 17 Key
	20360	Probe, Temperature

Intellitouch II

33 KEYS

ITEM NO.	PART NO.	DESCRIPTION
23	24434	Control, Intellitouch II
	32289	Probe, Temperature RTD 500 OHM
	31703	Knob, Control
	5279	Thermostat Back-Up KX-38-36
	19621	Switch, Rocker, DPDT, Black
	19620	Switch, Rocker, DPST, Black
	18587	Relay, 3PDT, 120VAC
	24721	Wiring Harness (Intellitouch II)
	31293	Decal, Back-Up Access
	22726	Decal, Thermostat/Switch
	22787	Decal, Control Intellitouch II
	24626	Cover, Control SS
	31315	Control, Arby's

Cook and Hold

MECHANICAL—MANUFACTURED BEFORE 1/85

ITEM NO.	PART NO.	DESCRIPTION
5	18868	Mode Selector Switch w/o Knob
6	16686	Knob, Mode Selector Switch
	6496	Blower Switch, SPST, Blue
	6498	Cool Down Switch, SPDT, Red
	16476	Logo/Instruction Decal
	17860	Wiring Harness, 115V(Between 7/84 & 1/85)
	90048	Wiring Harness, 115V (Before 7/84)
	17270	Control Panel, Porc.(Between 7/84 & 1/85)
	90018	Control Panel Decal (Before 7/84)

Cook and Hold

MECHANICAL—MANUFACTURED BETWEEN 1/85 & 7/86

ITEM NO.	PART NO.	DESCRIPTION
	17864	Timer, 12 Hour (After 4/19/85)
	17988	Timer, Conversion, 12 Hour w/Knob (Before 4/19/85)
	20347	Mode Selector Switch w/o Knob, 4 Pos.

ITEM NO.	PART NO.	DESCRIPTION
	16686	Knob, Mode Selector Switch
	15365	Thermostat, Hold Only
	16392	Knob, Hold Thermostat
	17854	Wiring Harness, 115V
	17904	Control Panel, Porc.

SOLID STATE—MANUFACTURED AFTER 7/86

ITEM NO.	PART NO.	DESCRIPTION
	5709	Indicator Light, Amber, Round (Hold Only)
	17864	Timer, 12 Hour (After 4/19/85)
	17988	Timer, Conversion, 12 Hour w/Knob (Before 4/19/85)
	20347	Mode Selector Switch w/o Knob, 4 Pos.
	20351	Controller, Hold Temperature (150-250°F)
	90043	Relay, Motor, DPDT, 120V, 30 Amp
	18587	Relay, 3PDT, 120V w/Bracket
6	16686	Knob, Replacement
	18666	Wiring Harness 1 SP
	20006	Wiring Harness 2 SP
	18745	Control Panel, Porc. 1 SP
	20007	Control Panel, Porc. 2 SP

Humidaire

ITEM NO.	PART NO.	DESCRIPTION
	18266	Indicator Light, 125V, Blue, Round
	18318	Timer, SS Steam Duration, 120V
	18439	Potentiometer, Steam Duration
	18580	Switch, Humidaire Momentary
	18314	Switch, Thermal
	18300	Valve, Water Solenoid, 120V, 60 HZ
	18310	Nozzle Assembly, Spray
	18384	Filter Assembly, Water
	18385	Filter, Cartridge Replacement
	18287	Control Panel, Porc., 8 Set Point
	18285	Control Panel, Porc., Infinite
	18366	Wiring Harness, Front
	35103	Wiring Harness, Rear

► NOTE: Units with the Humidaire features require 2 harnesses. One for the control circuit and one for the Humidaire controls.



Fan Delay with Pulse Points

ITEM NO.	PART NO.	DESCRIPTION
	15709	Indicator Light, 125V, Amber, Round
	15673	Indicator Light, 125V, Red, Round
	18290	Timer, 10 Minute, 115 VAC, 60 HZ
	18292	Timer, 30 Minute, 120 VAC, 60 HZ
	21051	Timer, SS, Pulsing, 120V
	16686	Knob, Control
	18587	Relay, 3PDT, 120V w/Bracket
	18358	Wiring Harness, SS (Infinite & 8 Set Point, Fan Delay 1SP)
	20019	Wiring Harness, SS (Infinite & 8 Set Point, Fan Delay 2 SP)
	18276	Control Panel, Porc., 8 Set Point 1 SP
	20042	Control Panel, Porc., 8 Set Point 2 SP
	18678	Control Panel, Porc., Infinite

Burner and Piping Components

ITEM NO.	PART NO.	DESCRIPTION
	18799	Steel Tube Burners (Set of 2) (After 1/86)
	19097	Steel Tube Burners (Set of 2) (Before 2/86)
	8717	Orifice (Set of 2) (Specify Model & Gas Type)
	90063	Shutter Only, Air
	3001	Locknut, Air Shutter
	15871	Manifold Assembly (After 12/85)
	21070	Tubing, Manifold (After 2/86)
	90023	Tubing, Manifold (Before 2/86)
	10252	Union 1/2"
	33249	Gas Flex Hose
	18242	Thru Pipe Assembly (After 1/86)
	16589	Thru Pipe Assembly (Before 2/86)
	16118	Coupling, Reducer 1/2" - 3/4"
	17861	Deflector (After 8/84) DFG-100
	90012	Deflector (Before 7/84) DFG-100
	17364	Deflector DFG-200
	90022	Combustion Compartment Shield
	21079	Secondary Air Duct (Set of 2)

Baking Compartment Components

ITEM NO.	PART NO.	DESCRIPTION
	20758	Interior Baffle, Porc. (Blower Wheel Cover)
	20864	Interior Baffle, SS (Blower Wheel Cover)
	8648	Screws, Baffle Mounting (Set of 4)
	8646	Brackets, Baffle Support (Set of 4)
	20642	Light Guards, Baffle (Set of 4)
8	15853	Blower Wheel, 10-3/4" Diameter
	19640	Screen Assembly, Baffle SS
	15891	Tube, Light
	4342	Lamp, 120V, 50W
	4922	Socket, Lamp
	15891	Tube Assembly, for Lamp
	19081	Rack Supports (Set of 2) (After 9/86) DFG-100
	90064	Rack Supports (Set of 2) (Before 9/86) DFG-100
	18768	Rack, Each (After 9/86) (20-7/8" x 28-1/4") DFG-100
	4701	Rack, Each (Before 9/86) (20-7/8" x 28-1/4") DFG-100
	21422	Rack Supports (Set of 2) DFG-200
	20246	Rack, Each (27-7/8" x 28-3/16") DFG-200
	19171	Stops, Rack (Set of 2)
	90027	Motor Mount & Panel Assembly
	17752	Compartment Liner Bottom, Porc. DFG100 (After 6/84)
	90026	Compartment Liner Bottom, Porc. DFG100 (Before 7/84)
	17753	Compartment Liner Bottom, SS DFG100 (After 6/84)
	90045	Compartment Liner Bottom, SS DFG100 (Before 7/84)
	20771	Compartment Liner Bottom, Porc. DFG-200
	20215	Compartment Liner Bottom, SS DFG-200
	20353	Thermostat Bulb Clip (Mech.)
	19751	Thermostat Clip SS

Door Components

ITEM NO.	PART NO.	DESCRIPTION
AFTER JULY, 1984		
	20806	Door Assembly Sid, LH
	20805	Door Assembly, Sid RH
	20804	Door Assembly w/GIs, LH
	20803	Door Assembly w/GIs, RH
BETWEEN JANUARY, 1983 & JULY, 1984		
	20169	Door Assembly Sid, LH
	20805	Door Assembly Sid, RH
	20170	Door Assembly w/GIs, LH
	20803	Door Assembly w/GIs, RH
BEFORE JANUARY, 1983		
	90040	Door Assembly Sid, LH
	90044	Door Assembly Sid, RH
	90008	Door Assembly w/GIs, LH
	90016	Door Assembly w/GIs, RH
	9036	Window Assembly, Drop In (10-1/8" x 17-1/8") (After 1/83)
	11867	Window Assembly, Drop In (20-1/2" x 14-1/4") (Before 1/83)
	17558	Door Handle, Porc. (After 6/84)
	18081	Top Plate, Door Handle (After 6/84)
	17403	Wooden Door Handle (Between 1/83 & 7/84)
	20358	Grip, for Wooden Door Handle (Between 1/83 & 7/84)
	15754	Door Handle, 14" (Before 1/83)
	8583	Door Catch, Striker Plate (Before 1/83)
	8584	Door Catch, Ball Plunger (Before 1/83)
	5742	Key, Spanner (Before 1/83)

ITEM NO.	PART NO.	DESCRIPTION
	4887	Chain & Turnbuckle, Door Operating
	90074	Sprocket Assembly (After 1/83)
	90007	Sprocket Assembly (Before 1/83)
	90017	Washers, Door (Set of 2)
	90004	Bushings, Door Hinge (Set of 2)
	16657	Sleeve, Upper Door Bushing
	17557	Hinge Pin, Upper Door
10	35702	Microswitch & Bracket Assembly, Door Replaces 19978 Units after 07/84
10	35918	Microswitch Assembly, Door Replaces 19978 Units before 07/84
	35419	Bracket, Door Switch (Microswitch)
	90077	Cam Assembly, Door Switch (After 1/83)
	90053	Cam Assembly, Door Switch (Before 1/83)
	17311	Center Trim, Door (After 1/83)
	16448	Pressure Lock (After 1/83)
	90037	Gasket Assembly, Center (Before 1/83)
	17519	Gasket Assembly, Perimeter (After 7/84)
	90010	Gasket Assembly, Perimeter (Before 7/84)
	90009	Arm, Lower Door w/Hinge Pin (Before 1/83)
	20359	Arm Assembly, Door LH (After 7/84)
	90075	Arm Assembly, Door LH (Before 7/84)
	90076	Arm Assembly, Door RH
	16487	Washer, Neoprene Mounts to Door Support for Switch (4 qty.)
	20659	Support Assembly, Lower Door (After 7/84)
	90072	Support Assembly, Lower Door (Between 1/83 & 7/84)
	90060	Support Assembly, Lower Door (Before 1/83)

REMEMBER...

The parts you see here are just a sample of what we carry!